

**Mounting Channels**

Universally slotted mounting channel profile

| Material specifications |   |
|-------------------------|---|
| <b>Material</b>         | DX51D or Equivalent steel<br>DD11 or Equivalent steel                     |
| <b>Coatings</b>         | Galvanized, Hot-Dip Galvanized (HDG),<br>Powder Coating*, Zinc Magnesium* |



**Applications**

- Installation of light to medium-duty ventilation ducts, plumbing & firefighting pipes and cable trays
- Secondary support structure for installation of different services.

**Features & Benefits**

- Wide range of mounting options in conjunction with our FXC mounting channel accessories
- Quick and efficient attachment of multiple support structure
- Lateral and vertical adjustment with reliable fastening
- High load bearing capacity owing to special material properties and design

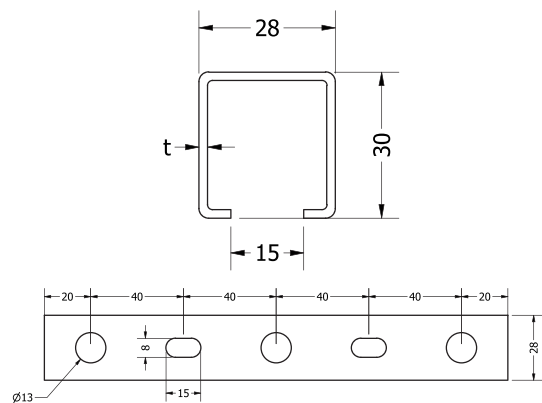

**Select Variant**

| Article No.     |           | Product Description                  | L (mm) | W (mm) | H (mm) | t (mm) |
|-----------------|-----------|--------------------------------------|--------|--------|--------|--------|
| Galvanized (vz) | HDG (fvz) |                                      |        |        |        |        |
| 300040          | 300041    | FXC Mounting Channel 28 30 1.75, 6 m | 6000   | 28     | 30     | 1.75   |
| 300050          | 300051    | FXC Mounting Channel 28 30 1.75, 3 m | 3000   | 28     | 30     | 1.75   |
| 300060          | 300061    | FXC Mounting Channel 28 30 1.75, 2 m | 2000   | 28     | 30     | 1.75   |

\*Available on request